

1

2

3

4

REV	CHANGE NUMBER	DATE
A	ECOWHT5861	3/4/09

C

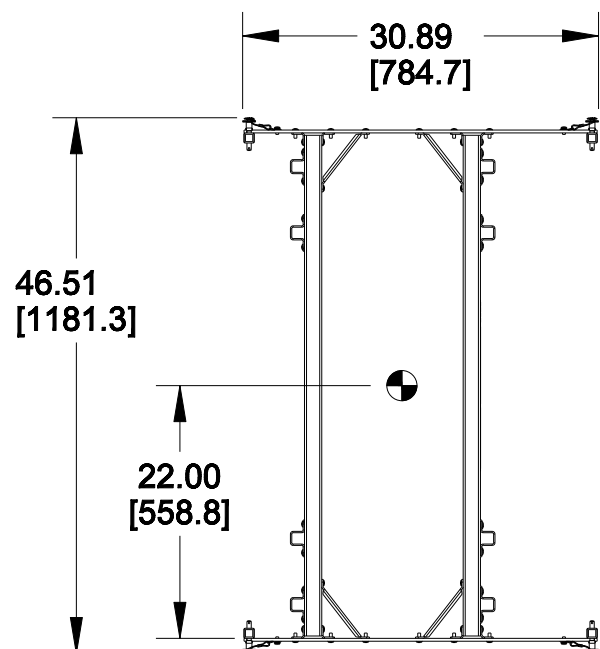

NOTES:

1. SYMBOL  INDICATES CENTER OF BALANCE.
2. WEIGHT APPROX. 50 lb [23 kg].
3. WHEN HINGES ARE IN THEIR STORAGE LOCATIONS THEY ARE FULLY CONTAINED WITHIN ADAPTER BAR DIMENSIONS.

4X STORAGE LOCATIONS,
SEE NOTE 3

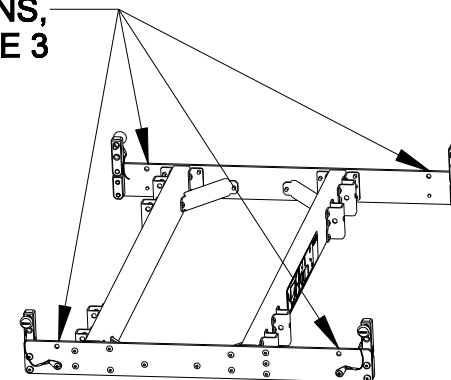

B

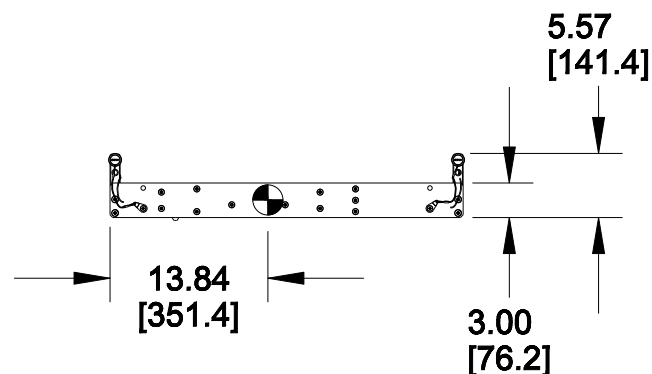

AB7674-73 ADAPTER BAR

A

THIRD ANGLE PROJECTION

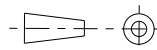

THE INFORMATION CONTAINED
HEREIN IS PROPRIETARY AND
CONFIDENTIAL PROPERTY OF
LOUD TECHNOLOGIES, INC.
ALL RIGHTS RESERVED

UNLESS OTHERWISE SPECIFIED:
ALL DIMENSIONS ARE IN INCHES
DUAL [MM] DIMENSIONS
FOR REF ONLY

TOLERANCE IN INCHES
LINEAR ± 0.13 in / ± 3.3 mm
ANGLES $\pm 1^\circ$

(X.XX) = REF DIMS
NO TOLERANCE IMPLIED

TSC = THEORETICAL SHARP CORNER

DIMENSIONS ACROSS CENTERLINES
TO BE SYMMETRICAL

EAW www.eaw.com

TITLE:
**DWG CUSTOMER
AB7674-73 ADAPTER BAR
[MECHANICAL SPECIFICATION]**

A

SHEET 1 OF 1

SCALE:
0.060

DRAWING NUMBER:

2034117-CD

REVISION:

A

PRO ENGINEER

1

2

3

4