

**NOTES:**

1. SYMBOL  $\odot$  INDICATES MOUNTING POINT, 3/8-16 THREADED HOLE (PI ANGLE).
2. SYMBOL  $\ominus$  INDICATES 2.75 [69.9] x 5.00 [127.0] x 5/16-18 MOUNTING PATTERN FOR CUSTOMER SUPPLIED MOUNTING SOLUTION.
3. SYMBOL  $\bullet$  INDICATES MOUNTING POINT, 3/8-16 THREADED HOLE (RIVNUT).
4. SYMBOL  $\oplus$  INDICATES CENTER OF BALANCE.
5. WEIGHT APPROX. 30 lb [13.6 kg].
6. SHIPPING WEIGHT APPROX. 36 lb [16.3 kg].

REV	CHANGE NUMBER	DATE
A	ECOWHT9667	8/22/13

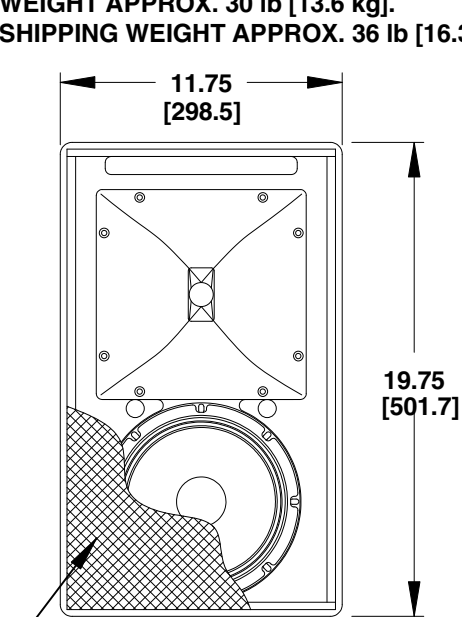

GRILLE PARTIALLY SHOWN

**FRONT**

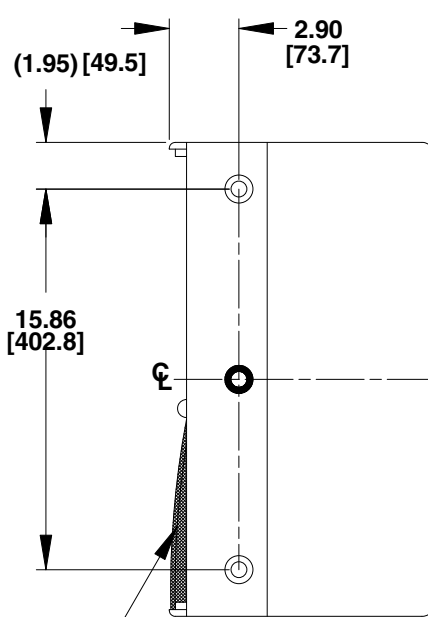

**RIGHT SIDE**  
DIMENSIONS APPLY  
TO BOTH SIDES

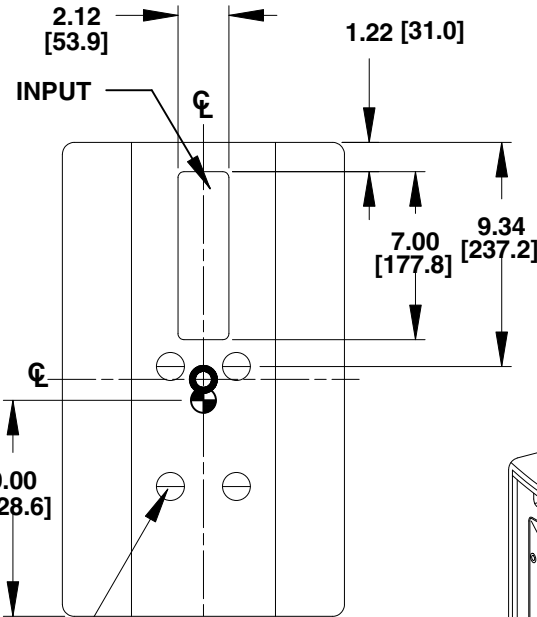

SEE NOTE 2  
**BACK**

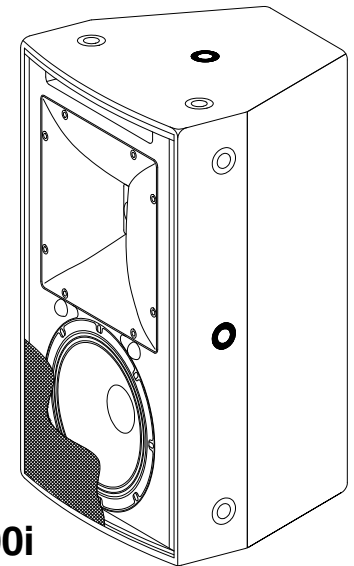

**MK8000i**

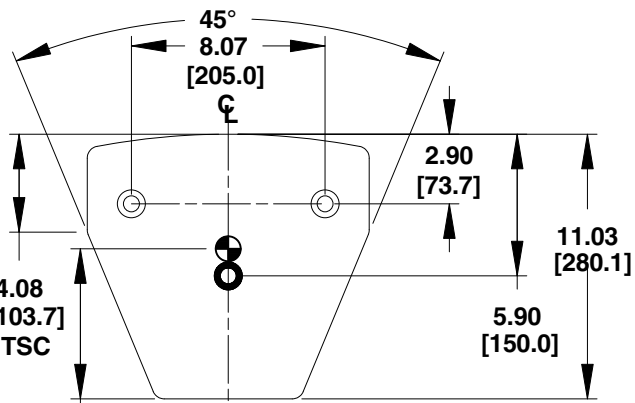

**BOTTOM**

DIMENSIONS APPLY TO TOP AND BOTTOM

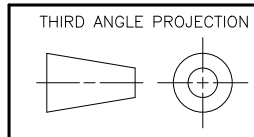

THE INFORMATION CONTAINED  
HEREIN IS PROPRIETARY AND  
CONFIDENTIAL PROPERTY OF  
LOUD TECHNOLOGIES, INC.  
ALL RIGHTS RESERVED

UNLESS OTHERWISE SPECIFIED:  
ALL DIMENSIONS ARE IN INCHES  
DUAL [MM] DIMENSIONS  
FOR REF ONLY

TOLERANCES  
LINEAR  $\pm 0.13$  in/  $\pm 3.3$  mm  
ANGLES  $\pm 1^\circ$

(X.XX) = REF DIMS  
NO TOLERANCE IMPLIED

TSC=THEORETICAL SHARP CORNER

DIMENSIONS ACROSS CENTERLINES  
TO BE SYMMETRICAL

**EAW** www.eaw.com

TITLE:  
DWG CUSTOMER MK8000i  
[MECHANICAL SPECIFICATION]

**A** SHEET 1 OF 1 SCALE: 1 TO 8

DRAWING NUMBER: 0031634-CD REVISION: A