





1

2

3

NOTES:

- 1. SYMBOL  INDICATES MOUNTING POINT 1/4-20 (T-NUT).
- 2. SYMBOL  INDICATES MOUNTING POINT 5/16-18 T-NUT FOR OMNI MOUNT SERIES 100.
- 3. SYMBOL  INDICATES MOUNTING POINT 5/16-18 T-NUT FOR ULTIMATE BRAND STAND.
- 4. SYMBOL  INDICATES MOUNTING POINT 3/8-16 T-NUT FOR EYE HOOK (STANDARD).
- 5. SYMBOL  INDICATES CENTER OF BALANCE.
- 6. WEIGHT APPROX. 28 LBS.
- 7. SHIPPING WEIGHT APPROX. 32 LBS.

REV	DESCRIPTION	APVD/DATE
1	UPDATED FORMAT TO CURRENT DESIGN STANDARDS PER ECD #4226 DM 11/8/99.	KFH 11/9/99

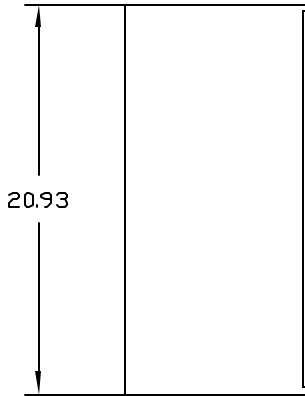
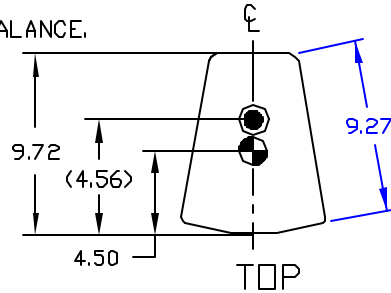

SIDES

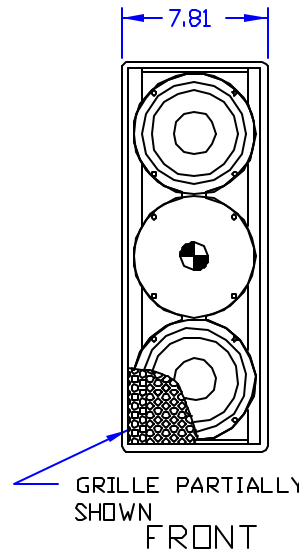

FRONT

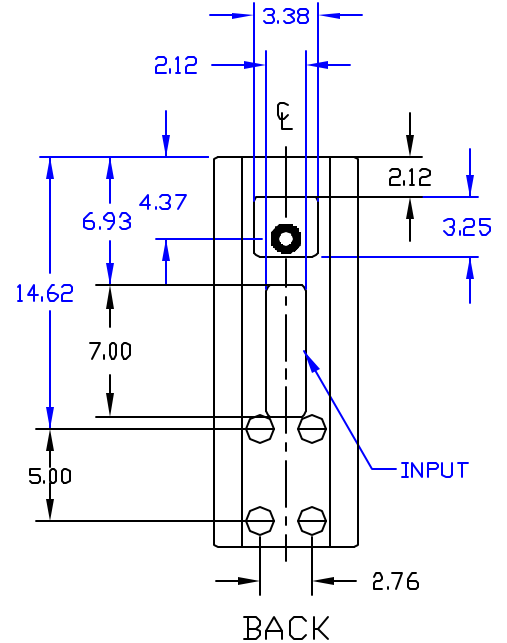

BACK

JF80

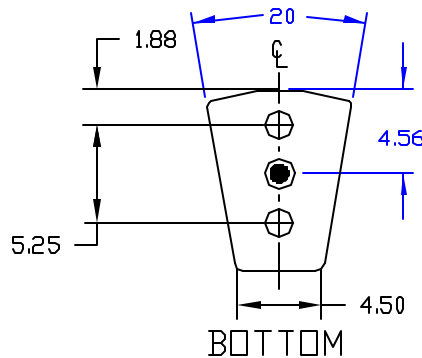
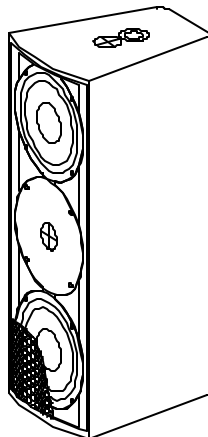

BOTTOM

DOCUMENT CONTROL PER SPECIFICATION 4.5.201

A

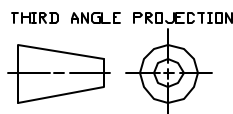

UNLESS OTHERWISE SPECIFIED: ALL DIMENSIONS ARE IN INCHES

TOLERANCE IN INCHES
XX ± .13
ANGLES ±11

(X.XX) = REF DIMS
NO TOLERANCE IMPLIED
T.S.C.=THEORETICAL SHARP CORNER
DIMENSIONS ACROSS CENTERLINES
TO BE SYMMETRICAL

STATUS: PRODUCTION

APPROVALS		DATE
DRAWN:	JRM	10/26/96
CHECKED:	N/A	N/A
DES ENG:	JR	4/1/96
MFG ENG:	JAY S	4/11/96

EA EASTERN ACOUSTIC WORKS
ONE MAIN STREET
 WHITEVILLE, PA 15388 USA

TITLE: CABINET/FINISHED/BLACK/JF80 [MECHANICAL SPECIFICATION]

A SHEET 1 OF 1 SCALE: 1 TO 10

DRAWING NUMBER: 510489 REVISION: 1

1

2

3

VELLUM