



# Installation Instructions VFR Series U-Brackets

**Warning: Installation should only be done by an experienced technician. Improper installation may result in damage to the equipment, injury or death.**

It is recommended that you consult a building professional for the proper mounting hardware before mounting the bracket. Due to various construction methods and materials, the hardware for securing the bracket to the mounting surface is not supplied.

## 1. Inventory

These instructions are for installing a VFR loudspeaker using a VFR Series U-Bracket.

Before beginning installation, inventory your available hardware to items listed.

Item	Qty	Description
A	1	U-Bracket
B	1*	Button Head Screw
C	2	Lock Washer
D	2	Flat Washer
E	2	Large Rubber Washer

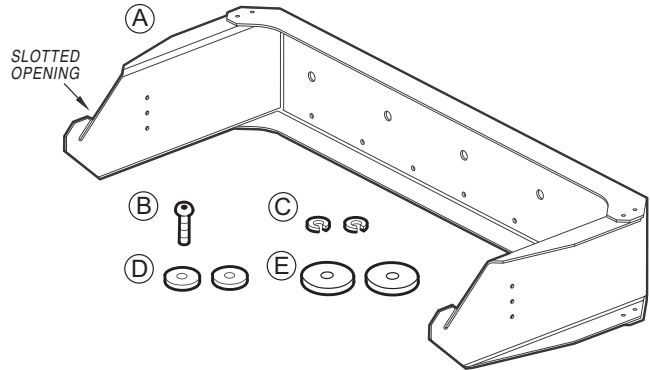

\*Note: UBKT-V6U does not include screws, as they are both integrated into the VFR Loudspeaker.

## 2. Removing the Existing Hardware

VFR U-Brackets are mounted to VFR loudspeakers using the button head screw located at the middle of the top of each loudspeaker and using the mounting hole at the front of the pole cup (or button head screw located at the middle of the bottom of a VFR69).

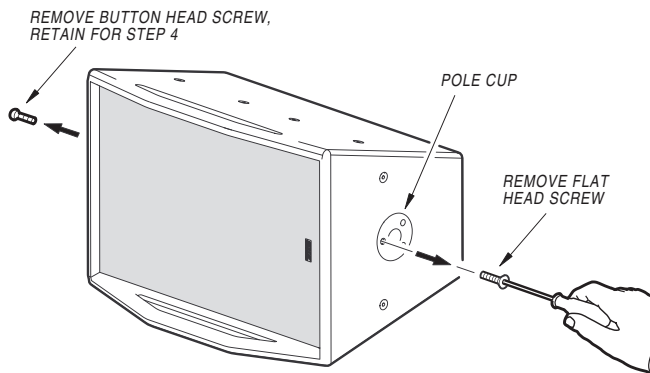

Remove the U-Bracket mounting hardware from opposing sides of the enclosure. Retain button head screw.

NOTE: For the VFR69, retain both button head screws for step 4.

## 3. Mounting the Bracket

When horizontally mounting an enclosure make sure the slotted openings in the bracket arms face upward.

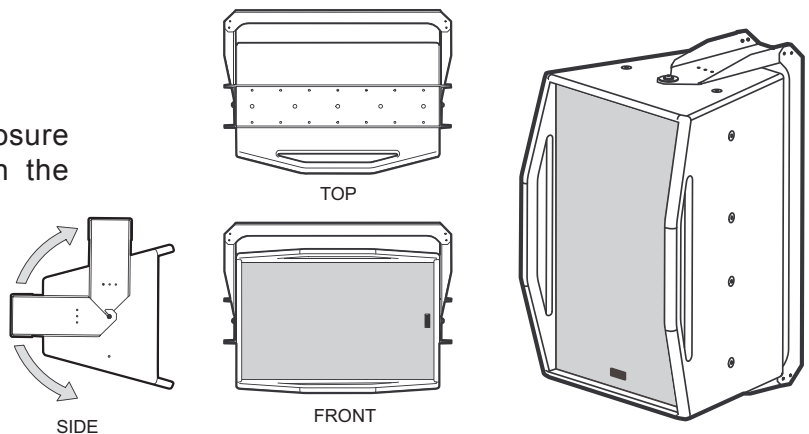

#### 4. Attaching the Hardware to the Enclosure:

Onto each of the two button head screws (B), place a lock washer (C), a flat washer (D) and a large rubber washer (E). Thread these screws and related hardware three complete turns into the U-Bracket mounting points.

Leave as large a space as possible between the large rubber washer (E) and the flat washer (D). Place the enclosure into the bracket slots with the large rubber washers (E) inside the bracket (A) and the flat washers (D) and lock washers (C) outside the bracket (A) as shown. Position to the desired angle and tighten screws (B) to 27lb-in [31 kg-cm].

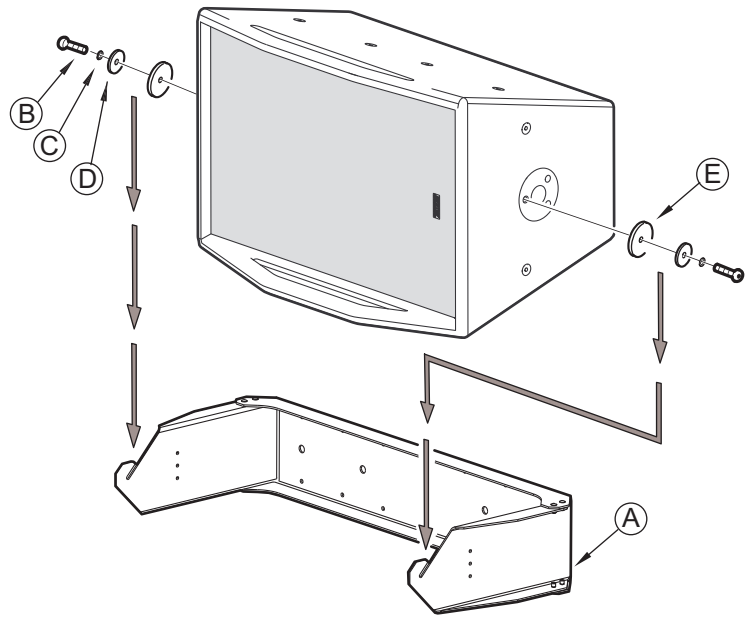

#### 5. Secure Angle

The VFR Series U-Brackets have multiple holes in the bracket arms. Accidental angle tampering may be prevented by screwing into the speaker through one of the holes in each arm with two user supplied #10 x 1/2" or M3.9 x 13mm self-tapping screws (one per side).

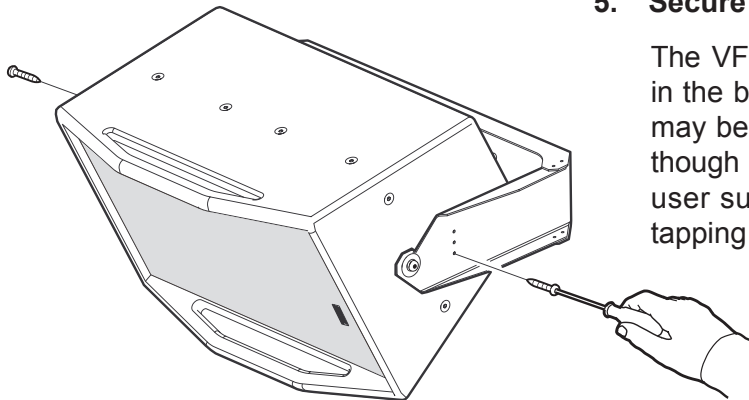

If you have questions about these VFR Series U-Bracket installations please contact the EAW Application Support Group:

Tel 800-992-5013 (USA only)  
Tel 508-234-6158  
Fax 508-234-8251  
E-mail [asg@eaw.com](mailto:asg@eaw.com)

**Thank you for purchasing  
EAW products**

