

REV	CHANGE NUMBER	DATE
A	ECOWHT8923	9/17/12

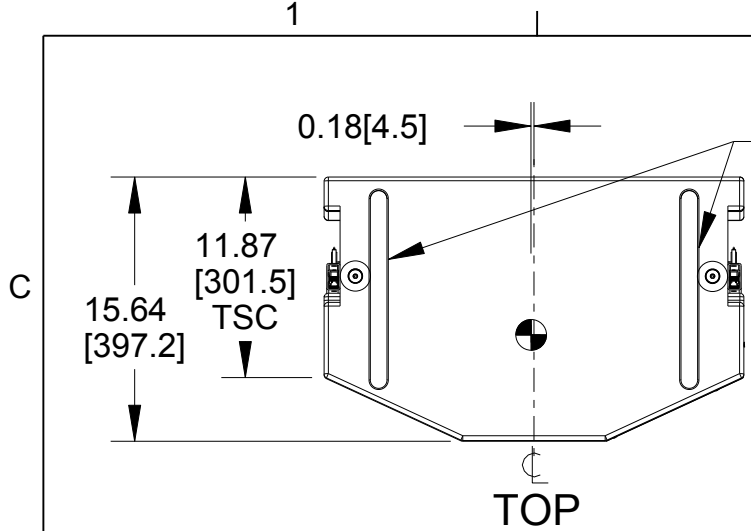

- NOTES:
1. SYMBOL \odot INDICATES MOUNTING POINT, M10 X 1.5 THREADED HOLE (PI ANGLE).
 2. SYMBOL \bullet INDICATES CENTER OF BALANCE.
 3. WEIGHT APPROX. 62 lb [28 kg].
 4. SHIPPING WEIGHT APPROX. 75 lb [34 kg].

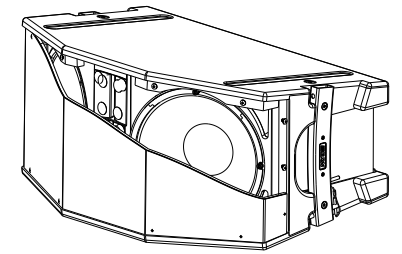

JFL213

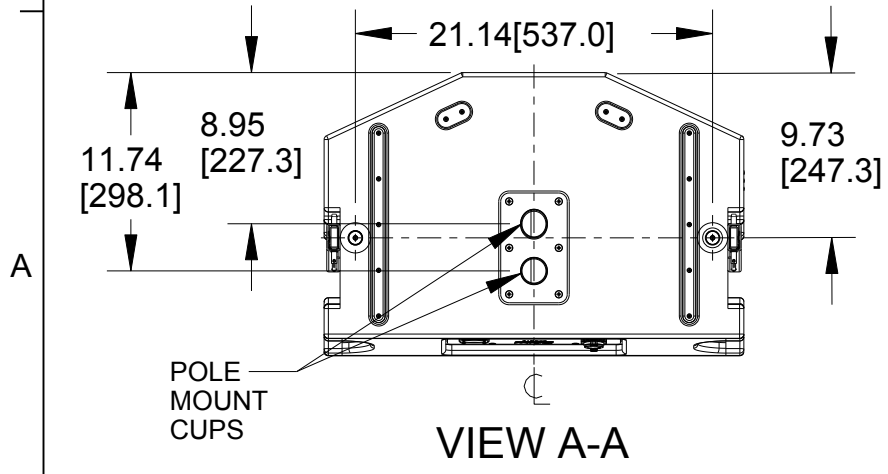
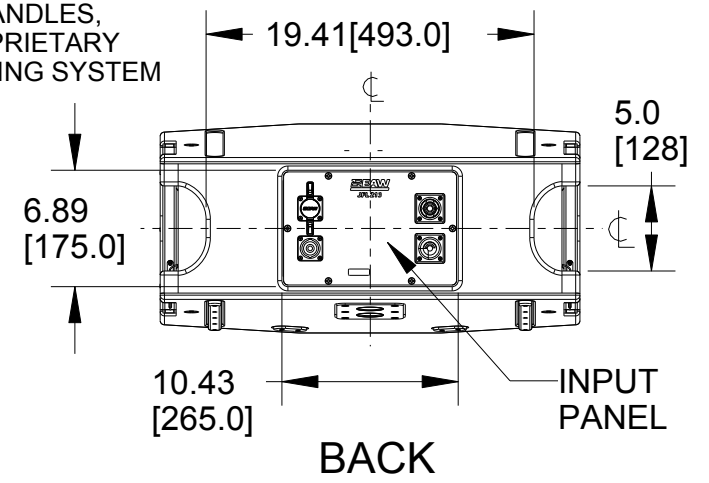
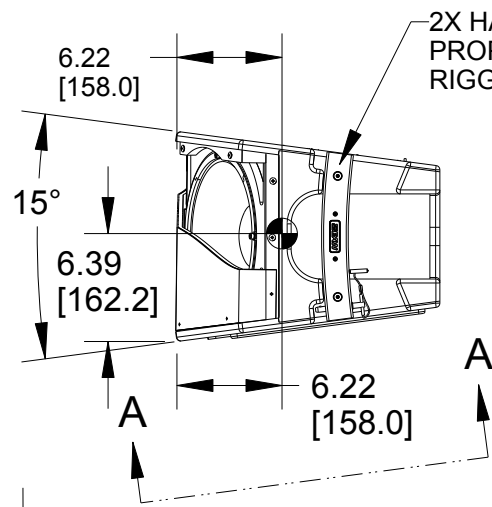
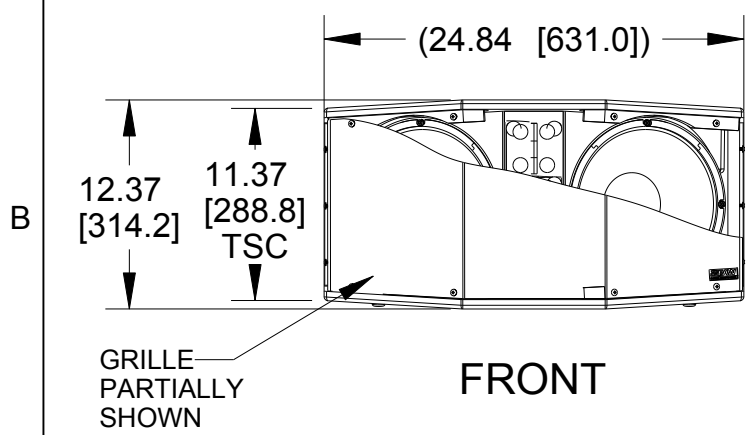

THIRD ANGLE PROJECTION

THE INFORMATION CONTAINED HEREIN IS PROPRIETARY AND CONFIDENTIAL PROPERTY OF LOUD TECHNOLOGIES, INC. ALL RIGHTS RESERVED

UNLESS OTHERWISE SPECIFIED: ALL DIMENSIONS ARE IN INCHES DUAL [MM] DIMENSIONS FOR REF ONLY

TOLERANCE IN INCHES
 LINEAR ± 0.13 in / ± 3.3 mm
 ANGLES $\pm 1^\circ$

(X.XX) = REF DIMS
 NO TOLERANCE IMPLIED

TSC = THEORETICAL SHARP CORNER

DIMENSIONS ACROSS CENTERLINES TO BE SYMMETRICAL

EAW www.eaw.com

TITLE:
DWG CUSTOMER JFL213
[MECHANICAL SPECIFICATION]

A	SHEET 1 OF 1	SCALE: 0.088
DRAWING NUMBER: 2039856-CD		REVISION: A