

EAW Installation Instructions

SB1001(2) or SB2001(2) Rigging Kit

Warning: Suspending loudspeakers should be done with extreme caution and by a certified professional who is qualified to determine the requirements for and to implement overhead rigging. Failure to follow proper precautions may result in damage to the equipment, injury, or death.

Introduction: These instructions enable the technician to install two rigging kits:
EAW ACC Rigging SB1001(2) P/N 2034943 to be installed onto the SB1001(2) Model Loudspeaker
EAW ACC Rigging SB2001(2) P/N 2035055 to be installed onto the SB2001(2) Model Loudspeaker

Inventory: Ensure your SB1001(2) or SB2001(2) Rigging Kit contains the following:

Item	Qty	Description
A	1	Tube-Hinge Assy Left SB1001(2) or
A	1	Tube-Hinge Assy Left SB2001(2)
B	1	Tube-Hinge Assy Right SB1001(2) or
B	1	Tube-Hinge Assy Right SB2001(2)
and		
C	10	Screw 1/4-20 x 1.25 Lg SHCS
D	10	Washer, Lock 1/4
E	10	Washer Flat 1/4
F	1	Instructions (This Sheet)

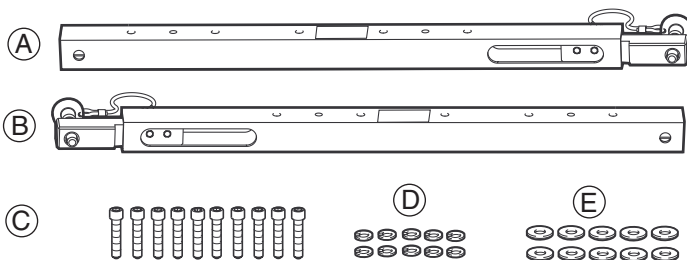

Tools Required:

- Power Drill
- 5/16" or 8mm Drill Bit
- #2 Phillips/Cross Screwdriver
- 3/16" Hex Key (Allen Wrench)

Disassembly: To access the loudspeaker's internal rigging mounting features some disassembly is required:

1. Remove the grille and foam assembly.
 - a. Removing the Phillips head screws around the perimeter of the grille, do not remove the screws in the center of the grille that retain the stiffener.
 - b. Carefully remove the grille and foam together. Do not discard grille assembly or screws.
2. Remove both the top and bottom handles.
 - a. They are each held to the loudspeaker with 12 Phillips head screws. Do not discard handles or screws.
3. Carefully lay the Loudspeaker onto one of its sides.

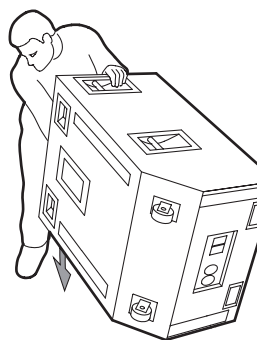
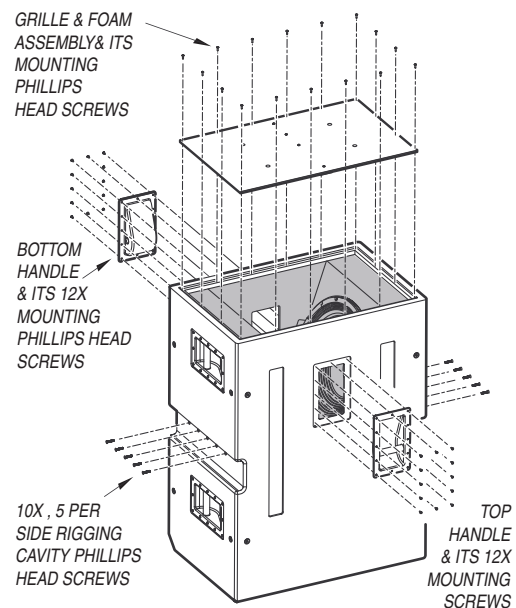

(Notice in the figure below, the bottom woofer is nearly flat to the floor.)

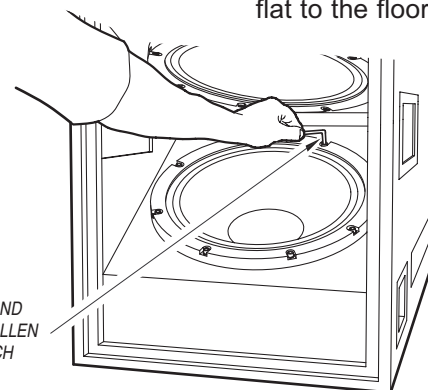

Removing The Bottom Woofer Hardware: Each woofer is held by 8 socket head cap screws and lock washers. A hand held 3/16 Allen wrench is needed to remove the deeper screws.

Removing The Woofer: After removing the 8 screws and lock washers (do not discard),

- Lift the woofer from the cabinet and place it on the floor.
- Press down on the red and black push button terminals to free the blue and black(or green) leads as you pull them from the connectors.

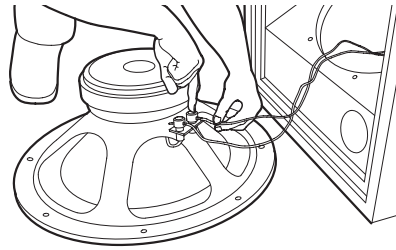

Turning The Cabinet A Second Time: Turn the cabinet so the remaining woofer sits nearly flat on the floor.

Removing The 2nd Woofer: Repeat the steps used when removing the 1st woofer; remove the mounting screws and disconnect the blue and black(or green) leads.

Leave the Cabinet on it's side after this step.

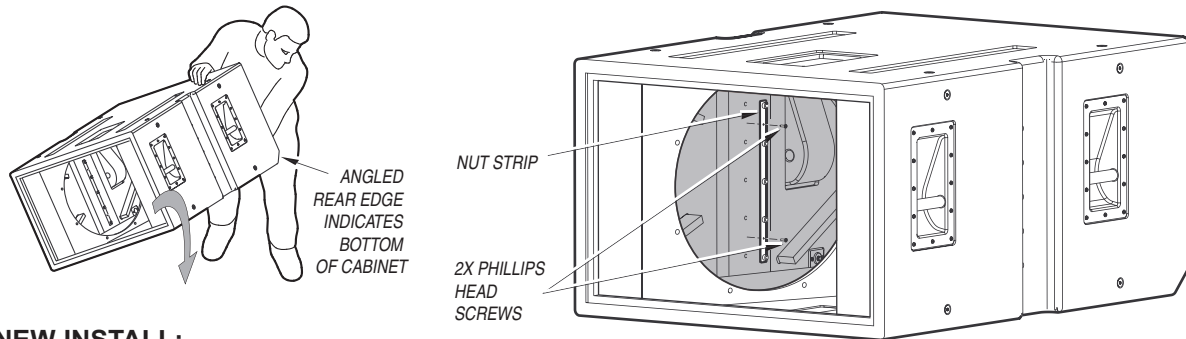

FOR NEW INSTALL:

Drilling The Pilot Holes:

1. Locate the five conical dimples on the recessed panel of each side.
2. Using the Hand Drill and 5/6" [8mm] drill bit, drill holes through the cabinet walls in these locations.
(Keep the drill bit as close to vertical as possible)

FOR REPLACEMENT AND NEW INSTALL:

Installing The Right And Left Rigging Assemblies:

1. Remove damaged rigging and dispose of it in a responsible manner to ensure it cannot be reused.
2. From inside the cabinet, insert an assembled screw, lock washer, and flat washer through each of the 5 holes as shown and thread into the rigging assembly (note the yellow labels on both tube-hinge assemblies should be toward the back of the cabinet).
3. After all 5 screws with their lock washer and flat washer have been fully threaded into the rigging assembly torque all to 5 ft-lbs.
4. Flip cabinet to other side and repeat the drilling and installation procedures.
5. Install the other rigging assembly in the similar way.

RIGHT RIGGING ASSEMBLY (AS VIEWED FROM THE BACK OF THE CABINET)

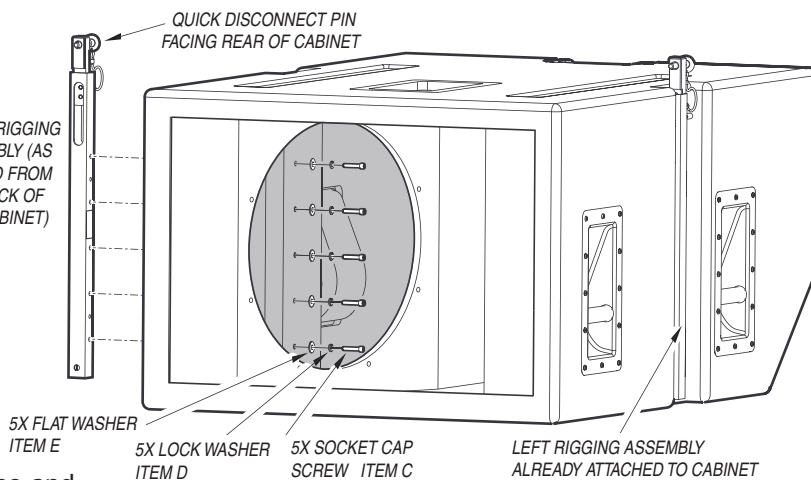

Reassemble Cabinet:

1. Reassemble the two woofers with blue lead to red terminal, black (or green) lead to black terminal.
2. Reinstall the top and bottom handles and the grille assembly. Do not over tighten hardware.

If you have questions about these SB1001(2)/SB2001(2) Rigging Kit Installation Instructions please contact the EAW Application Support Group:

The Laws of Physics | The Art of Listening

EAW

One Main Street, Whitinsville, MA 01588 tel: 800 992 5013 / 508 234 6158 fax: 508 234 8251 web: www.eaw.com e-mail: asg@eaw.com

RD0517 (B) OCTOBER 12 EAW is the worldwide technological and market leader in the design and manufacture of high-performance professional loudspeaker systems.