

# AC6 Stinger Instructions

These instructions are to provide a detailed step by step procedure for using the AC6 Stinger kit.

## Available Parts (**NOTE:** These are not part of a kit)

Part #	Part Name	Quantity	Reference
2071927-9999	PLATE LOCKING ASSY	1	A
2071924	M5X20 FLH SKT SS BLK	7	B
2071918-9999	Slide Plate	1	C
2072045-9999	Stinger Mount	2	D
2072041-9999	Stinger	2	E
2071404-9999	Mohawk	1	F

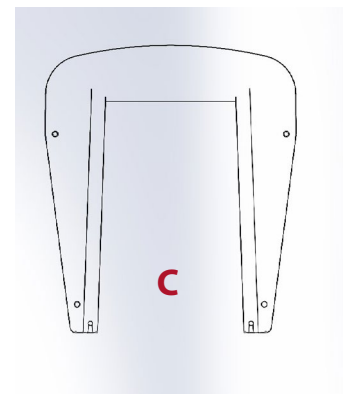
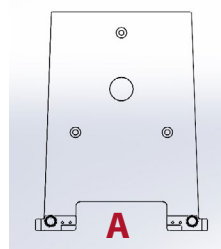
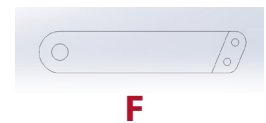
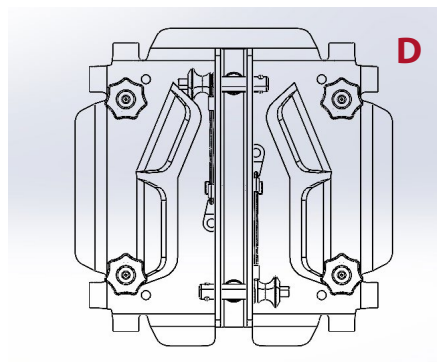
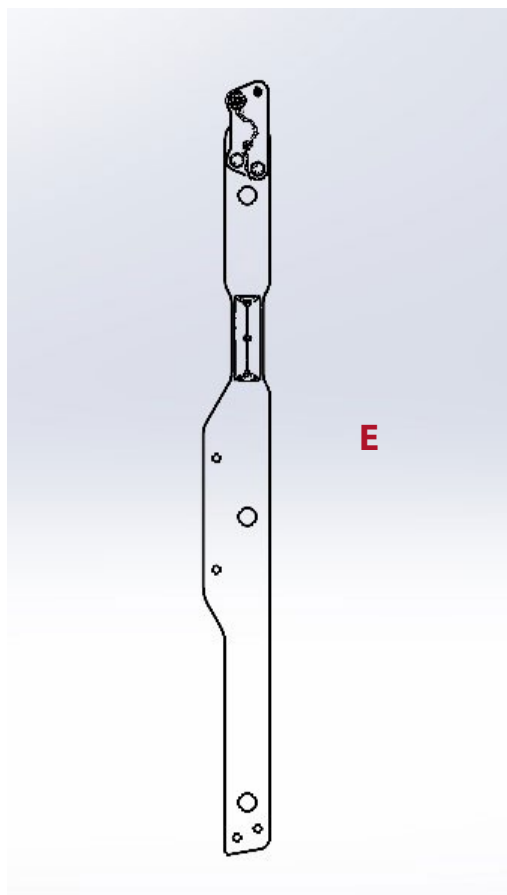

# AC6 Stinger Instructions

## Prepare AC6 for Stacking

1. Attach Locking Plate (A) to the top of the first AC6
  - Remove 3x M5x12mm screws from top of AC6 (Figure 1).
  - Position Locking Plate over open holes, then use 3x screws (B) to secure plate to the cabinet (Figure 2)

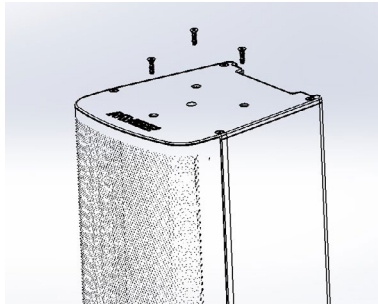

Figure 1 - Remove screws

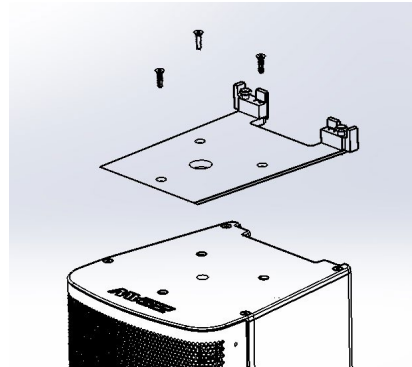

Figure 2 - Install Locking Plate

2. Attach slide plate (C) to bottom of next AC6
  - Remove 4x M5x12mm screws from bottom of AC6 (Figure 3).
  - Position Slide Plate over open holes, then use 4x screws (B) to secure plate to the cabinet (Figure 4)

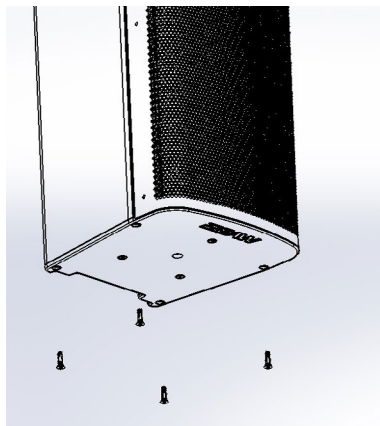

Figure 3 - Remove screws

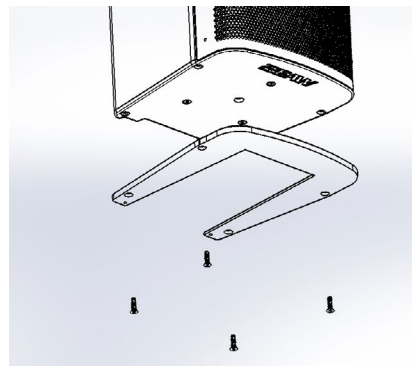

Figure 4 - Install Slide Plate

# AC6 Stinger Instructions

## Connect two AC6 Column loudspeakers with stacking plates

### 3. Attach two AC6 columns

- Slowly lay down AC6 with slide plate grill down on a rug or blanket
- Insert next unit with locking plate to connect (Figure 5)
- On rear of first AC6 locking plate, rotate both screw knobs clockwise to lock into position.

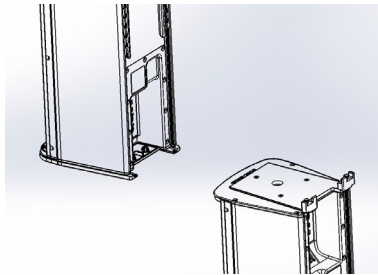

Figure 5 - Attach AC6 columns

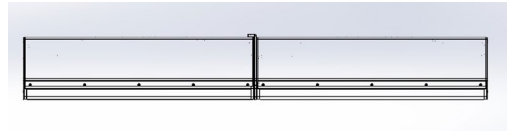

Figure 6 - AC6 columns grill down

## Attach Stinger to AC6 Array

### 4. Attach Stinger Mounts (D) to AC6

- Center the mount on the Flytracks for each AC6 (Figure 6)
- Turn the knobs on the mount clockwise to lock into place.

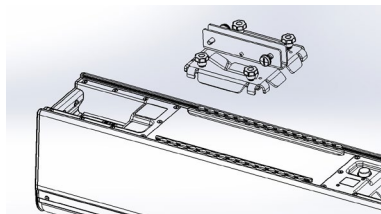

Figure 7 - Position Mount

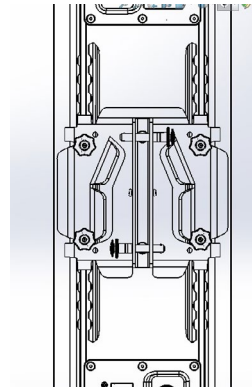

Figure 8 - Stinger Mount attached

# AC6 Stinger Instructions

## 5. Attach Stinger (E) to Mounts

- Place stingers in place on the mounts (Figure 9)
- Use supplied pins to secure the two stingers together
- Using pins on mount, secure stinger assembly to mount plates (Figure 10)

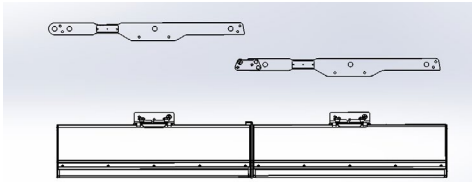

Figure 9 - Position Stingers on mounts

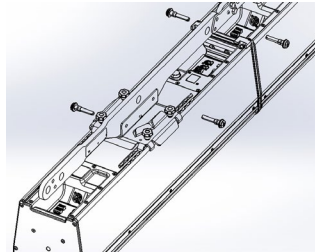

Figure 10 - Pin stinger assembly to mount plate

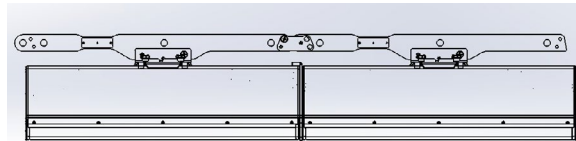

Figure 11 - Stingers assembled with AC6 array

## 6. Attach Mohawk (F) and suspend/fly array

- Attach Mohawk with pins at the end of the stinger (Figure 12)
- Once all pins and knobs are verified as secure, suspend array using a shackle.

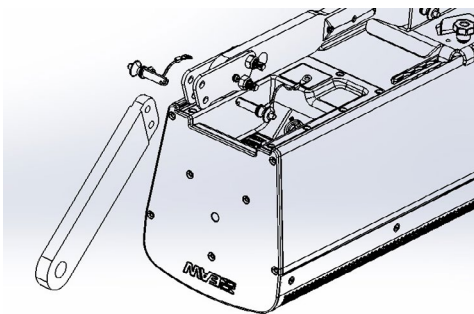

Figure 12 - Attach Mohawk to Stinger

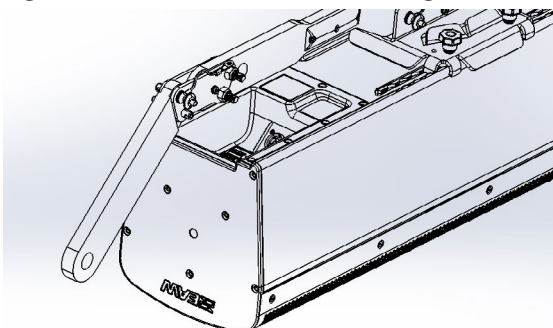

Figure 13 - Mohawk installed on Stinger

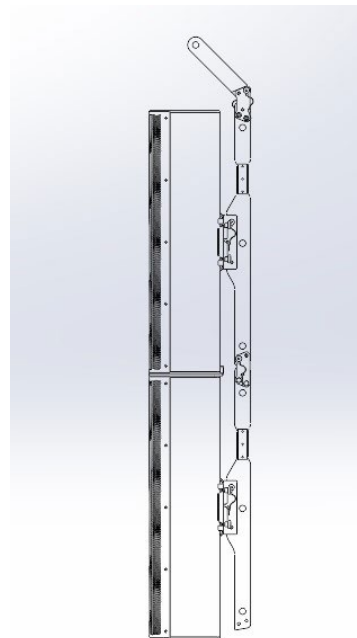

Figure 14 - Completed Stinger Array